

Pedigree Cats Inc.



PC 75 Power

Styling by Phil Aylsworth

On the drawing board, this new cat will please the most discriminating of tastes. The expansive flybridge allows entertainment and comfort for several people while below is a spacious galley and helm with extra seating. The master stateroom spans the full width of the hull, with all the creature comforts of a luxurious master bedroom and bath. The guest staterooms, offices, workstations, etc. can be built into the hulls per the owners individual tastes. For standard amenities, see the amenities and pricing listing on this site.

This boat is capable of doing about 26 knots with 2x900 Hp diesel engines. Possible alternatives would include using 4 smaller diesel engines, doing about 20 knots with better fuel economy (running on two of the engines), and more dependability. Alternatives also include water jet propulsion and bulb nose swath technology for long range cruising.

Pedigree Cat 75' Catamaran		
Length Overall	75'0"	22.9m
Beam Overall	36'	11m
Draft	30"	
Power	2x 420 hp diesels	



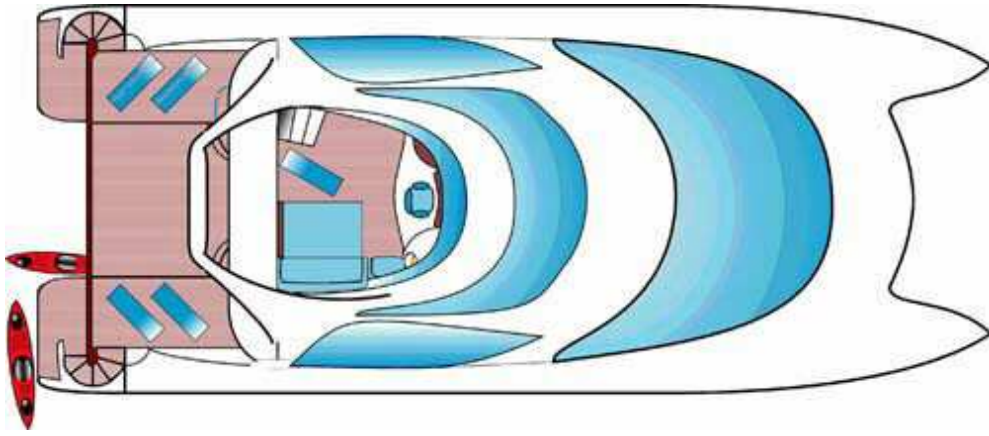

Layout

Main Salon Level

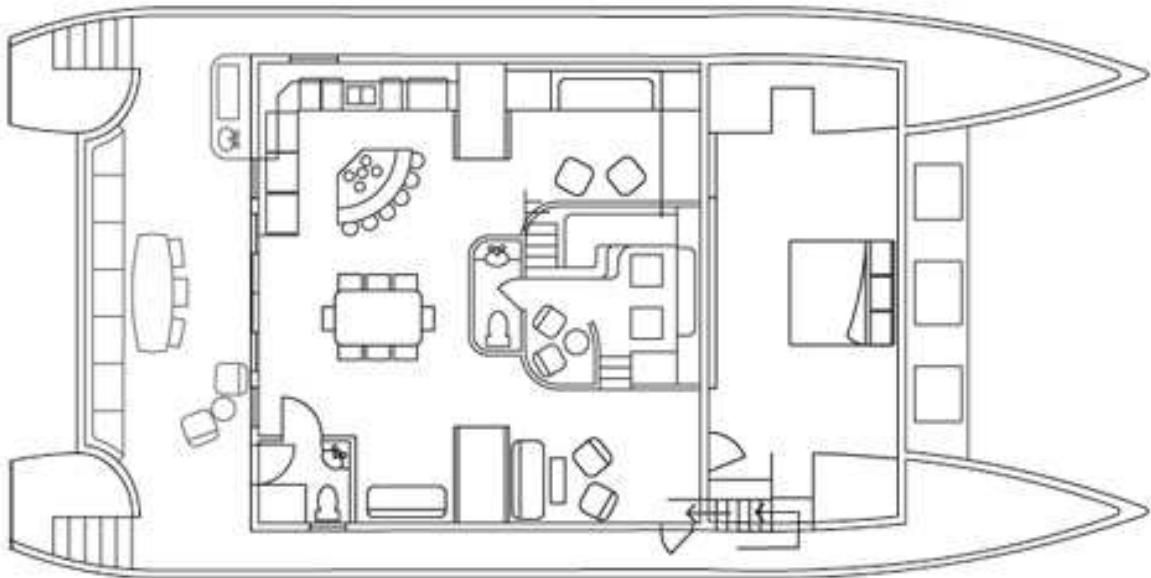

Hull

Forward - Master Bath and Closets
Mid - Guest Staterooms Level

Aft - Engines & Storage

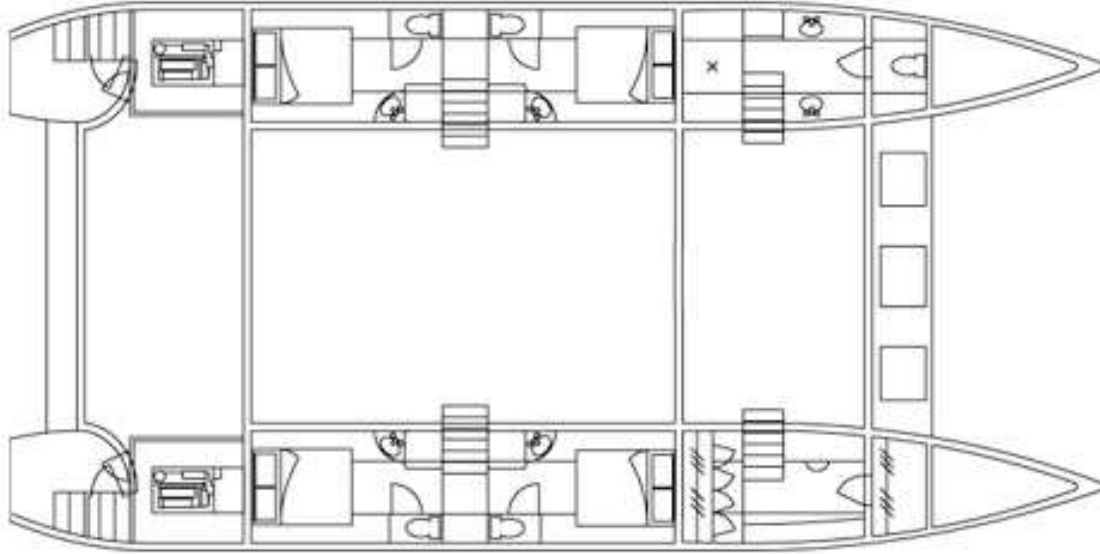

Flybridge

